

TREE PERMIT

City of Bettendorf, Iowa

Director of Parks and Recreation
1609 State Street, Bettendorf, IA 52722
(563) 344-4113

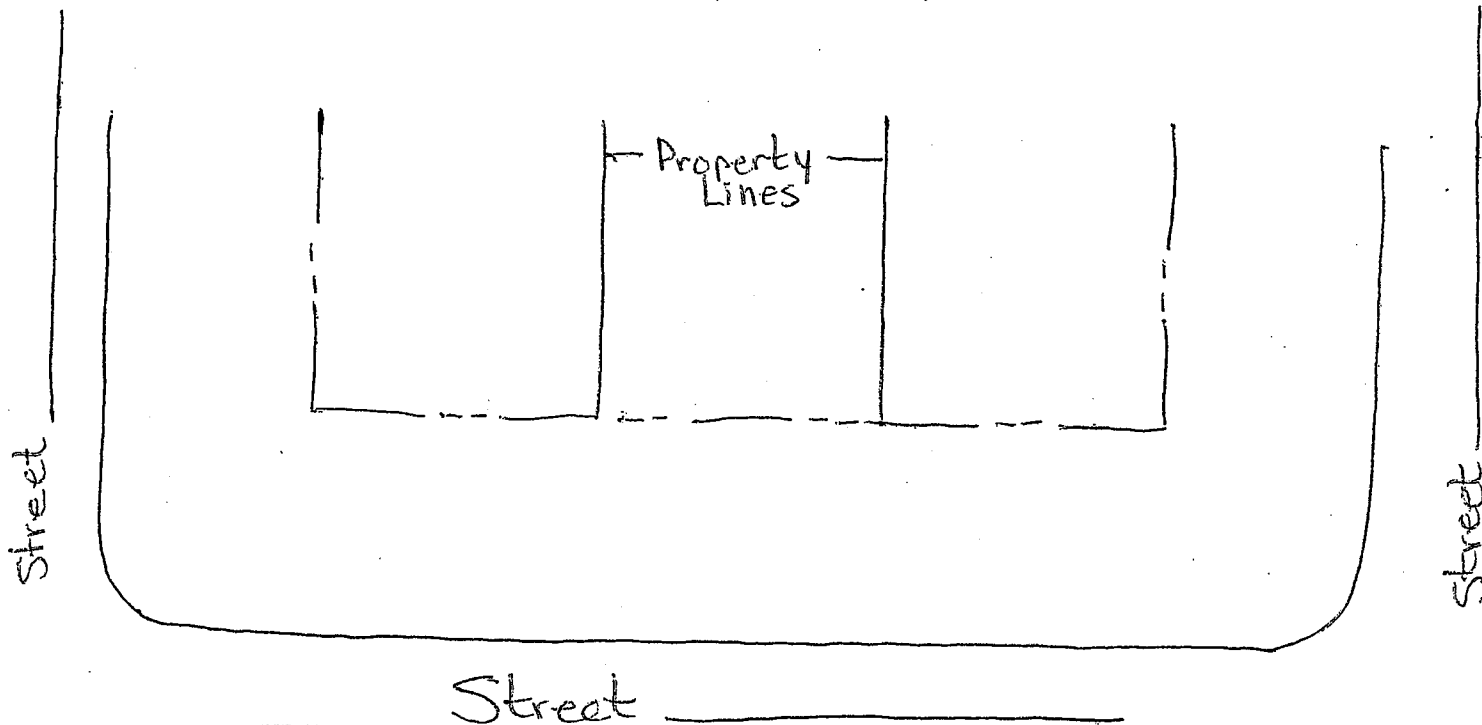

Property Owner: _____
Address: _____
Phone: home _____ work _____
Email address: _____

The property owner should locate Items 1 - 10 on above drawing, showing your property and the two adjacent properties.

1. Show location of power poles.
2. Show location of all utilities including gas, water, sanitary sewer, storm sewer, electric, phone, cable, and fiber optic, if applicable. Call One-Call to have utilities marked 1-800-292-8989. (Indicate whether buried or overhead.)
3. Show location of street lights.
4. Show location of fire hydrants.
5. Show location of present trees and shrubs.
6. Show location of proposed tree(s).
7. Show distance of proposed tree(s) to sidewalks, curbs and drives.
8. Show distance between proposed tree(s) and existing tree(s).
9. If corner lot, show distance of proposed tree to corner.
10. Include north arrow for direction clarification.

Please complete Page 2

Tree(s) to be planted _____
Quantity Species

I have read the ordinance pertaining to Planting & Maintenance of Trees on Public Property and agree to abide by the regulations as stated therein.

Owner Signature Date

Permission is hereby granted to plant _____ tree(s)
Quantity Species
at _____
Address

Permit Granted _____
Date Director's Signature